



OYSTER 595

CENTREBOARD



OYSTER

O Y S T E R 5 9 5 C E N T R E B O A R D
F R E E D O M T O E X P L O R E

Open a world of shallow cruising grounds and secluded bays with the Oyster 595, available with centreboard keel.

With an impressive draft reduction from 2.68m/8'10" to 1.8m/5'10", the Oyster 595CB enables access to hidden coves, secluded beaches, and the world's shallow cruising grounds.

MORE OPTIONS

The Oyster 595CB is extremely versatile and well appointed centreboard variant of our stunning 60 foot bluewater cruiser. She offers outstanding sailing performance, with the excitement of the shallow-draft, without compromise. Designed for safe, yet fast, exhilarating cruising and equipped with the latest automated sailing systems, she delivers responsive fingertip control on the helm. Her increased hull volume and wide beam aft can handle plenty of sail power for faster passage-making speeds.

Below decks, she offers a generous open saloon, with stylish mood lighting and entertainment all controlled through the Oyster Command System™.

The standard, four-cabin layout has space for eight family and friends, with an optional crew cabin and three heads for comfort and convenience. She has a large cockpit, protected helm positions and flush decks forward and aft. Designed and hand-crafted to Oyster's renowned build quality, she is a pleasure to sail, whether you're island-hopping in the Mediterranean or rounding the Cape.

FEATURES

- **Centreboard keel**
- **Reduced draft of 1.8m/5'10"**
- **Standard four cabin configuration**
- **Hydraulic push-button, in-mast furling**
- **Alternative interior layouts**
- **Twin rudder, centreboard or fixed keel options**
- **Large cockpit and protected twin helms**
- **Clutter-free flush teak deck**
- **Opening forward windows**
- **Option for extended transom**
- **Large full-width lazarette and watertight sail locker**
- **Retractable bow and stern thrusters as standard**
- **Generator as standard**
- **Easily accessible engineering features**
- **Lloyd's Register certified hull and deck moulding**



O Y S T E R 5 9 5 C E N T R E B O A R D

EXTERIOR





≈O≈











O Y S T E R 5 9 5 C E N T R E B O A R D

INTERIOR





OAK INTERIOR







WALNUT INTERIOR







WALNUT INTERIOR





CHERRY INTERIOR





CHERRY INTERIOR





CHERRY INTERIOR





MAPLE INTERIOR





MAPLE INTERIOR





CHART TABLE



DAYBED



ENGINE ROOM

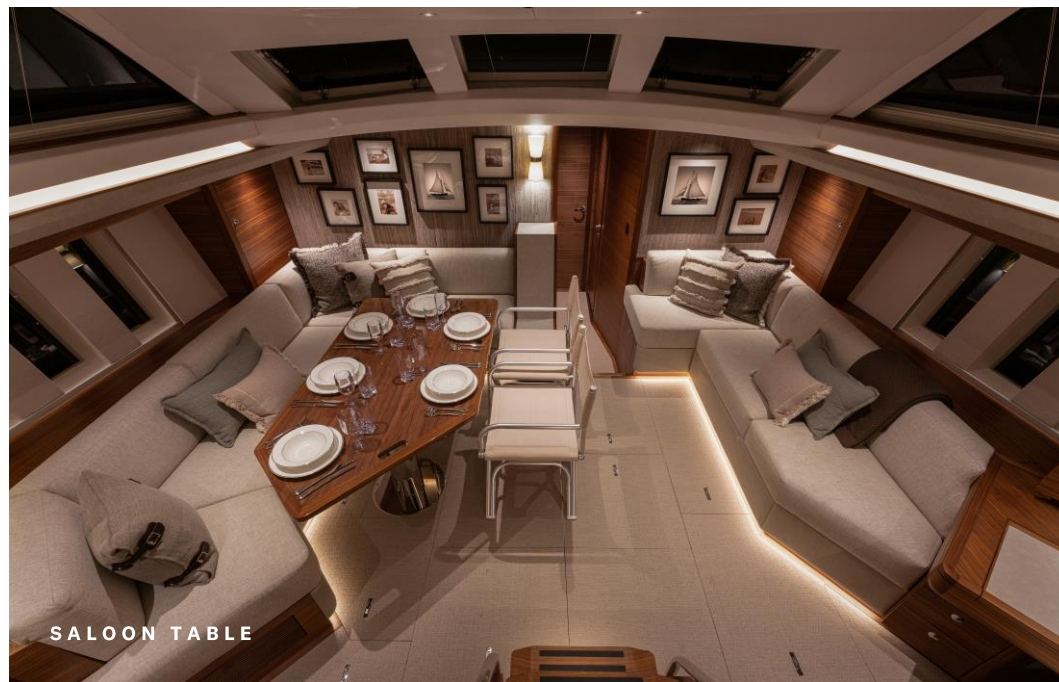

SALOON TABLE



O Y S T E R 5 9 5 C E N T R E B O A R D

S P E C I F I C A T I O N



O Y S T E R 5 9 5 C E N T R E B O A R D

S P E C I F I C A T I O N

Length overall including stemhead	19.05m / 62'6"
Length of hull	18.14m / 59'6"
Length of waterline	16.81m / 55'2"
Beam	5.36m / 17'7"
Draft - centreboard up	1.79m / 5'10"
Draft - centreboard down	4.06m / 13'4"
Displacement - standard keel	30,807kg / 67,918lbs
Typical engine	Yanmar 4LV-150 110kW (150hp)
Tanks - fuel	1,420 litres / 312 Imp Gallons (375 US gals)
Tanks - water	1,140 litres / 250 Imp Gallons (301 US gals)
Sail area including 110% foretriangle (IMF)	167.00m ² / 1798ft ²
Sail area including 110% foretriangle (Slab Reef)	177.00m ² / 1905ft ²
Air draft approx, excluding antennae	26.81m / 88'0"



O Y S T E R 5 9 5 C E N T R E B O A R D

PLANS



OYSTER 595 CENTREBOARD
SAIL PLAN



OYSTER 595 CENTREBOARD
CENTREBOARD KEEL



OYSTER 595 CENTREBOARD
STANDARD DECK PLAN



OYSTER 595 CENTREBOARD
DECK PLAN WITH BATHING PLATFORM



OYSTER 595 CENTREBOARD

DECK PLAN WITH EXTENDED TRANSOM AND BATHING PLATFORM

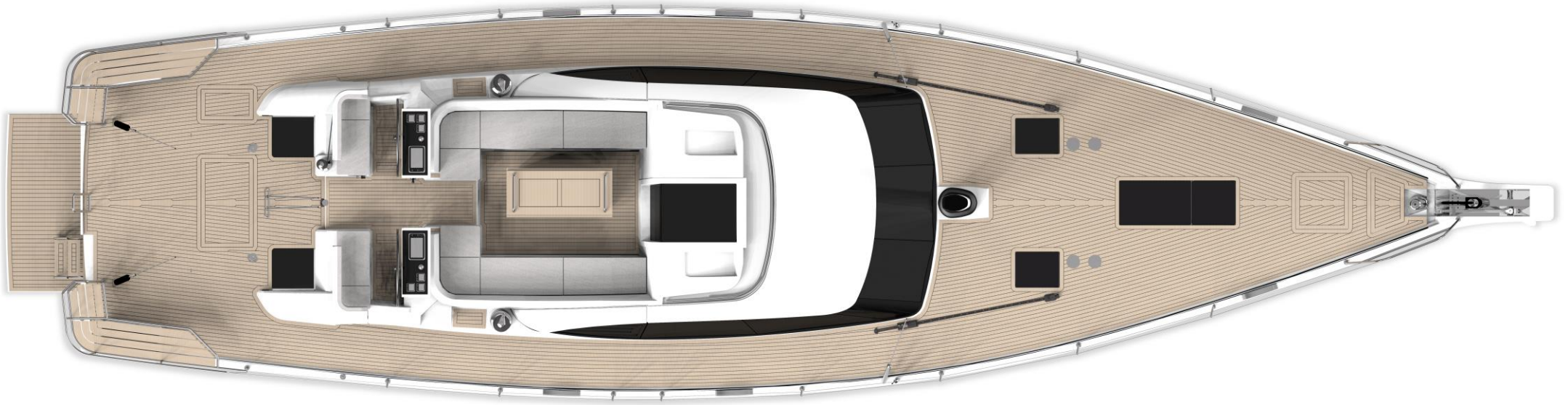

OYSTER 595 CENTREBOARD
STANDARD INTERIOR LAYOUT

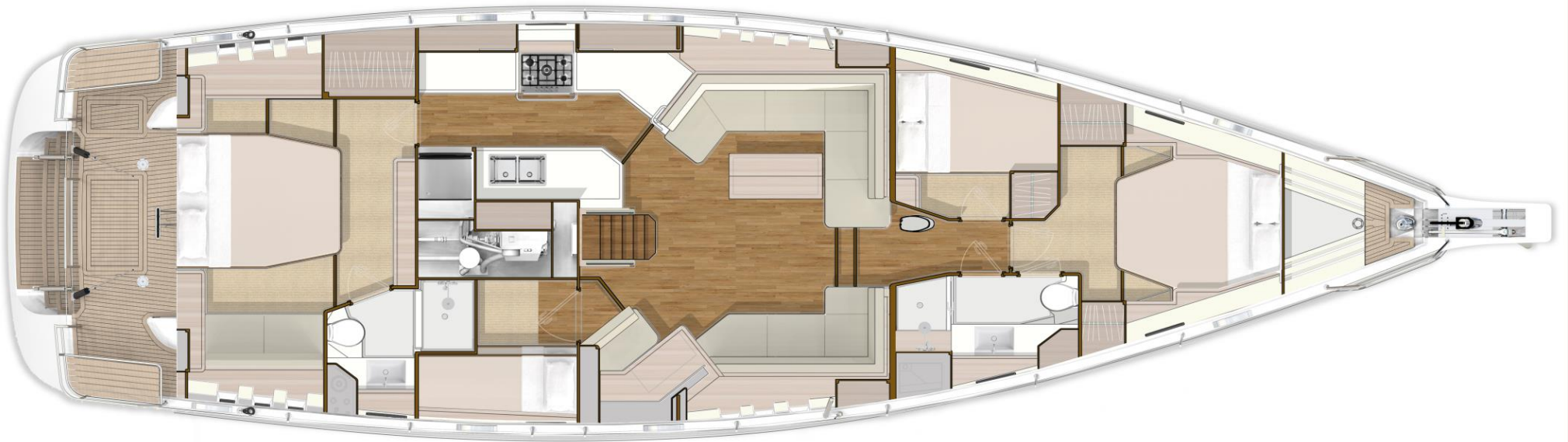

OYSTER 595 CENTREBOARD

ALTERNATIVE CONCEPT LAYOUT 1 – SUBJECT TO FINAL DESIGN



OYSTER YACHTS. THE WORLD IS YOURS.

For more information call: +44 (0) 1473 851 436 or email sales@oysteryachts.com



